

**School Of  
Electrical, Computer &  
Telecommunications Engineering  
UOW**

**Student Technical Orientation**

**SECTE  
Orientation**

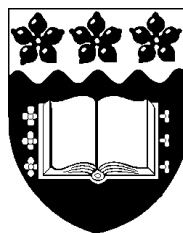

**Version: 1.0**



**Document Owner:** Laboratory Manager, SECTE

**Author:** Sasha Nikolic

### Document Control:

Version	Date	Author	Reason
1.0	18/02/2009	Sasha Nikolic	Initial Document for new students



**DOCUMENT CONTROL: ..... 2**

**INTRODUCTION ..... 4**

**USING SECTE COMPUTERS ..... 4**

**SOFTWARE INCLUDING VIRTUAL MACHINES ..... 4**

**SECTE WEBSITE ..... 5**

**WORKSHOP & STORES..... 5**

**RULES..... 6**



## Introduction

The School of Electrical, Computer and Telecommunications Engineering (SECTE) provides students with a number of resources. Understanding of the resources available and understanding the rules are essential to student development. This document provides students with a basic introduction to the school. Detailed information can be found on the SECTE website

The key items students need to know are:

- How to log into the computers for the first time
- How to open a VM session
- The SECTE website
- What and where is the Workshop and Stores
- What can be done at the stores
- Rules

## Using SECTE Computers

SECTE computers run on a separate network (domain) to the rest of the university. That means when you log onto a computer in a SECTE building your computer account is different to the one you may use in other parts of the university.

Everyone has a computer account created by ITS, which is the main IT department of the university. ITS provide you with a login id. SECTE uses the same login id provided to you by ITS, however as we run our own network we do not synchronise your password. As a result all passwords need to be set the first time you login to our domain. These passwords are then reset at the beginning of each year.

Steps to reset your password can be found at:

<http://www.uow.edu.au/informatics/elec/resources/technicalsupport/index.html#ITSupport>

## Software including Virtual Machines

SECTE uses a large variety of software packages in its computer laboratories. We use both Windows and Linux.

In the our Digital Lab which is room 35.129 (the room you will use the most) and in the Control Lab (35.136) we use what is called Virtual Machines. That is an operating system on top of another operating system.

Only the most basic software is installed on the base operating system. All other software is accessed by using the Virtual Machine software.

Procedures for using Virtual Machines can be found at:

<http://www.uow.edu.au/informatics/elec/resources/technicalsupport/index.html#ITSupport>

The other laboratories Electronic Lab (35.132), Telecommunications Lab (35.137) and the Frank Paoloni Lab (35.130) do not use Virtual Machines. All the software is found on the base system.



## SECTE Website

All students need to be aware of the SECTE website which is located at the following address:  
<http://www.uow.edu.au/informatics/elec/>

All relevant information regarding the school can be found at this location.

In particular students need to become aware of the Technical Support Page located under resources.

<http://www.uow.edu.au/informatics/elec/resources/technicalsupport/>

This page provides you with a wealth of information in regards to your interaction with the Technical Support of this school. As an example you will find information on how to contact relevant parties to obtain support, information about purchasing and borrowing, forms that may be required for you to fill in and so forth.

## Workshop & Stores

The Workshop located in 35.128 is the source of the schools IT and electrical staff. You will find that they will become very useful when it is time to start working on some projects. What the staff do and how to contact staff is described on the Technical Support website.

The Stores (35.132A) is a location that you need to become very familiar with. From the Stores you can pick up marked assignments/reports, borrow equipment, obtain lab access and so forth as described on the Technical Support Website.

Please note that the Stores is only open for limited hours of the day.

The location of the Workshop and Stores can be seen in the diagram below:

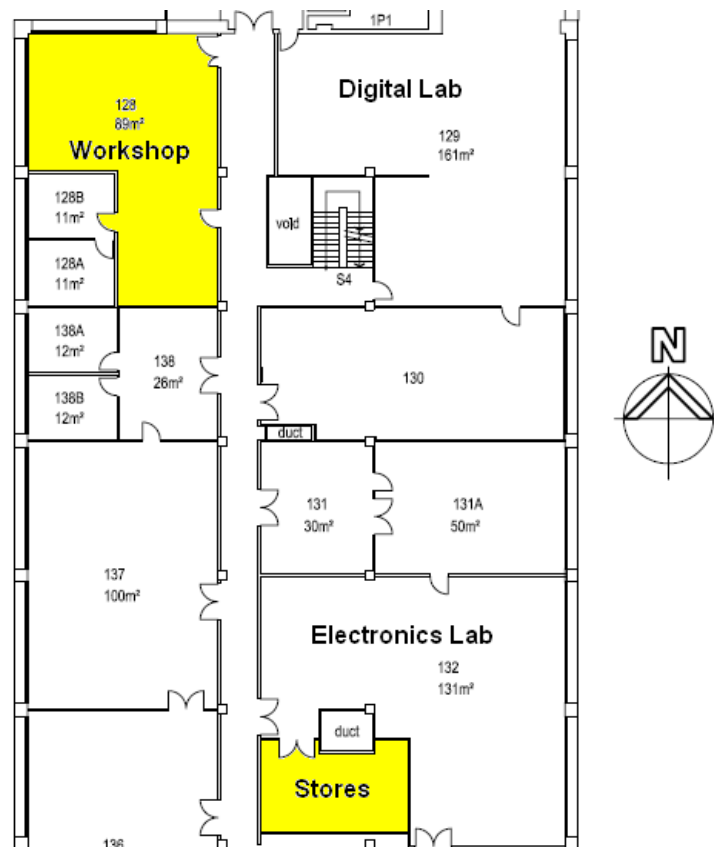



## Rules

Engineering can be a dangerous environment to work in and as a result all staff and students must follow a number of rules/procedures set up by the school/university to ensure the safety of everyone.

Detailed SECTE OH&S information can be found at:

<http://www.uow.edu.au/informatics/elec/resources/technicalsupport/index.html#OHS>

All first year students will be automatically enrolled in a school OH&S course via Web Vista. This must be completed by week 4. Failure to do so will mean that you will not be able to participate in any of the scheduled laboratory classes in SECTE.